

# ALDI Store, Mon Bank, Newport - Soft Landscape Proposals

- KEY**
- Proposed Tree Planting
  - Proposed Hedge Planting
  - Proposed Ornamental Shrub Planting
  - Proposed Native Shrub Planting
  - Proposed Grass Seeding / Turfing

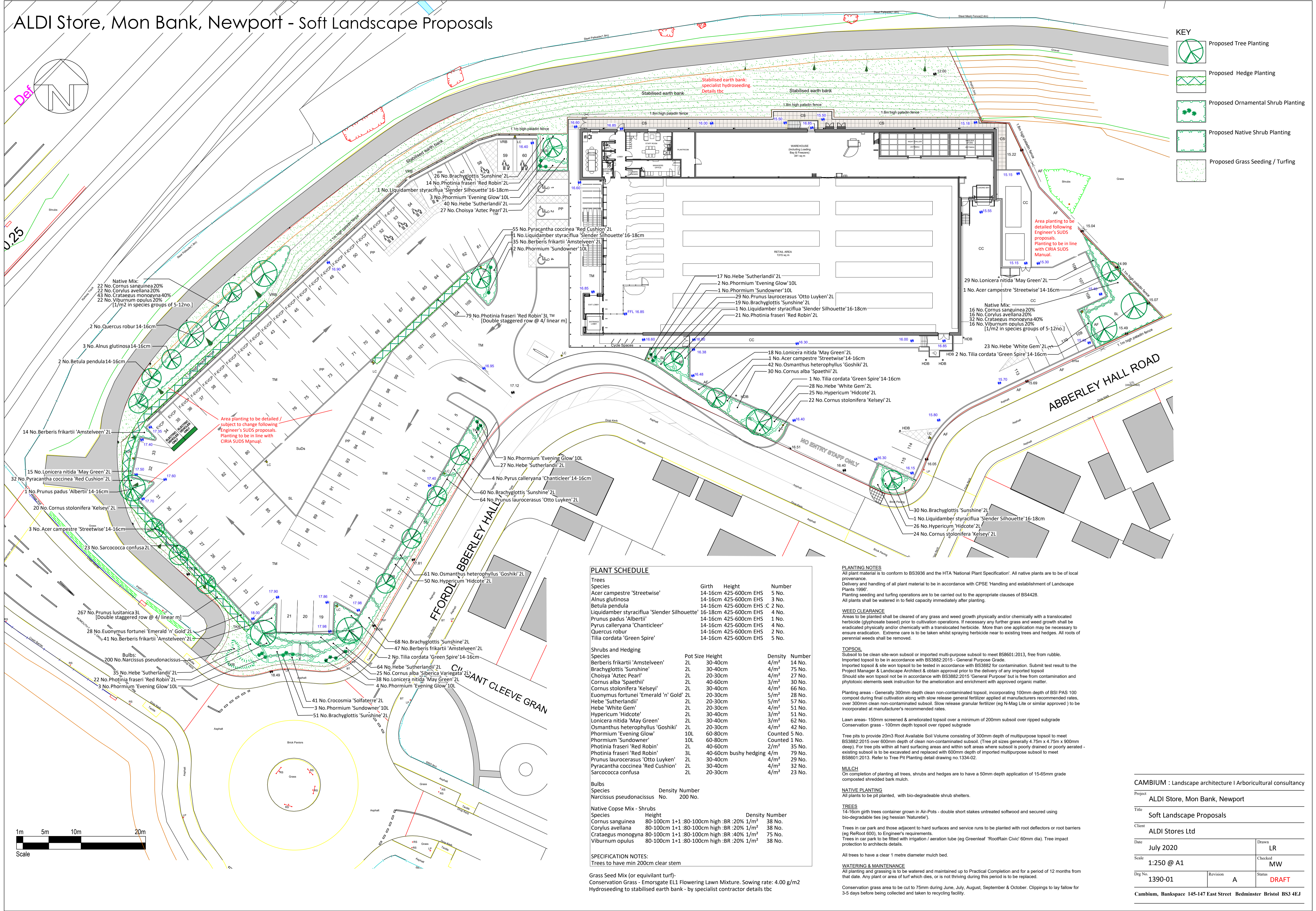

**PLANT SCHEDULE**

| Species                                      | Girth   | Height        | Number |
|--|---------|---------------|--------|
| Acer campestre 'Streetwise'                  | 14-16cm | 425-600cm EHS | 5 No.  |
| Alnus glutinosa                              | 14-16cm | 425-600cm EHS | 3 No.  |
| Betula pendula                               | 14-16cm | 425-600cm EHS | 2 No.  |
| Liquidambar styraciflua 'Slender Silhouette' | 16-18cm | 425-600cm EHS | 4 No.  |
| Prunus padus 'Albertii'                      | 14-16cm | 425-600cm EHS | 1 No.  |
| Pyrus calleryana 'Chanticleer'               | 14-16cm | 425-600cm EHS | 4 No.  |
| Quercus robur                                | 14-16cm | 425-600cm EHS | 2 No.  |
| Tilia cordata 'Green Spire'                  | 14-16cm | 425-600cm EHS | 5 No.  |

| Species                             | Pot Size | Height                | Density          | Number |
|-------------------------------------|----------|-----------------------|------------------|--------|
| Berberis frikartii 'Amstelveen'     | 2L       | 30-40cm               | 4/m <sup>2</sup> | 14 No. |
| Brachyglottis 'Sunshine'            | 2L       | 30-40cm               | 4/m <sup>2</sup> | 75 No. |
| Choisya 'Aztec Pearl'               | 2L       | 20-30cm               | 4/m <sup>2</sup> | 27 No. |
| Cornus alba 'Spaethii'              | 2L       | 40-60cm               | 3/m <sup>2</sup> | 30 No. |
| Cornus stolonifera 'Kelseyi'        | 2L       | 30-40cm               | 4/m <sup>2</sup> | 66 No. |
| Euonymus fortunei 'Emerald n' Gold' | 2L       | 20-30cm               | 5/m <sup>2</sup> | 28 No. |
| Hebe 'Sutherlandii'                 | 2L       | 20-30cm               | 5/m <sup>2</sup> | 57 No. |
| Hebe 'White Gem'                    | 2L       | 20-30cm               | 4/m <sup>2</sup> | 51 No. |
| Hypericum 'Hidcote'                 | 2L       | 30-40cm               | 3/m <sup>2</sup> | 51 No. |
| Lonicera nitida 'May Green'         | 2L       | 30-40cm               | 3/m <sup>2</sup> | 62 No. |
| Osmanthus heterophyllus 'Goshiki'   | 2L       | 20-30cm               | 4/m <sup>2</sup> | 42 No. |
| Phormium 'Evening Glow'             | 10L      | 60-80cm               | Counted          | 5 No.  |
| Phormium 'Sundowner'                | 10L      | 60-80cm               | Counted          | 1 No.  |
| Photinia fraseri 'Red Robin'        | 2L       | 40-60cm               | 2/m <sup>2</sup> | 35 No. |
| Photinia fraseri 'Red Robin'        | 3L       | 40-60cm bushy hedging | 4/m              | 79 No. |
| Prunus laurocerasus 'Otto Luyken'   | 2L       | 30-40cm               | 4/m <sup>2</sup> | 29 No. |
| Pyracantha coccinea 'Red Cushion'   | 2L       | 30-40cm               | 4/m <sup>2</sup> | 32 No. |
| Sarcococca confusa                  | 2L       | 20-30cm               | 4/m <sup>2</sup> | 23 No. |

| Species                  | Density | Number  |
|--------------------------|---------|---------|
| Narcissus pseudonacissus | No.     | 200 No. |

| Species            | Height       | Density                                  | Number |
|--------------------|--------------|--|--------|
| Cornus sanguinea   | 80-100cm 1+1 | .80-100cm high :BR :20% 1/m <sup>2</sup> | 38 No. |
| Corylus avellana   | 80-100cm 1+1 | .80-100cm high :BR :20% 1/m <sup>2</sup> | 38 No. |
| Crataegus monogyna | 80-100cm 1+1 | .80-100cm high :BR :40% 1/m <sup>2</sup> | 75 No. |
| Viburnum opulus    | 80-100cm 1+1 | .80-100cm high :BR :20% 1/m <sup>2</sup> | 38 No. |

**SPECIFICATION NOTES:**  
Trees to have min 200cm clear stem

Grass Seed Mix (or equivalent turf)  
Conservation Grass - Emorsgate EL1 Flowering Lawn Mixture. Sowing rate: 4.00 g/m<sup>2</sup>  
Hydroseeding to stabilised earth bank - by specialist contractor details tbc

**PLANTING NOTES**  
All plant material is to conform to BS3936 and the HTA 'National Plant Specification'. All native plants are to be of local provenance. Delivery and handling of all plant material is to be in accordance with CPSE 'Handling and establishment of Landscape Plants 1996'. Planting seeding and turfing operations are to be carried out to the appropriate clauses of BS4428. All plants shall be watered in to field capacity immediately after planting.

**WEED CLEARANCE**  
Areas to be planted shall be cleared of any grass and weed growth physically and/or chemically with a translocated herbicide (glyphosate based) prior to cultivation operations. If necessary any further grass and weed growth shall be eradicated physically and/or chemically with a translocated herbicide. More than one application may be necessary to ensure eradication. Extreme care is to be taken whilst spraying herbicide near to existing trees and hedges. All roots of perennial weeds shall be removed.

**TOPSOIL**  
Subsoil to be clean site-won subsoil or imported multi-purpose subsoil to meet BS8601:2013, free from rubble. Imported topsoil to be in accordance with BS3882:2015 - General Purpose Grade. Imported topsoil & site won topsoil to be tested in accordance with BS3882 for contamination. Submit test result to the Project Manager & Landscape Architect & obtain approval prior to the delivery of any imported topsoil. Should site won topsoil not be in accordance with BS3882:2015 'General Purpose' but is free from contamination and phytotoxic elements seek instruction for the amelioration and enrichment with approved organic matter.

Planting areas - Generally 300mm depth clean non-contaminated topsoil, incorporating 100mm depth of BSI PAS 100 compost during final cultivation along with slow release general fertilizer applied at manufacturers recommended rates, over 300mm clean non-contaminated subsoil. Slow release granular fertilizer (eg N-Mag Lite or similar approved) to be incorporated at manufacturer's recommended rates.

Lawn areas- 150mm screened & ameliorated topsoil over a minimum of 200mm subsoil over ripped subgrade  
Conservation grass - 100mm depth topsoil over ripped subgrade

Tree pits to provide 20m<sup>3</sup> Root Available Soil Volume consisting of 300mm depth of multipurpose topsoil to meet BS3882:2015 over 600mm depth of clean non-contaminated subsoil. (Tree pit sizes generally 4.75m x 4.75m x 900mm deep). For tree pits within all hard surfacing areas and within soft areas where subsoil is poorly drained or poorly aerated - existing subsoil is to be excavated and replaced with 600mm depth of imported multipurpose subsoil to meet BS8601:2013. Refer to Tree Pit Planting detail drawing no. 1334-02.

**MULCH**  
On completion of planting all trees, shrubs and hedges are to have a 50mm depth application of 15-65mm grade composted shredded bark mulch.

**NATIVE PLANTING**  
All plants to be pit planted, with bio-degradable shrub shelters.

**TREES**  
14-16cm girth trees container grown in Air-Pots - double short stakes untreated softwood and secured using bio-degradable ties (eg hessian 'Naturetie').

Trees in car park and those adjacent to hard surfaces and service runs to be planted with root deflectors or root barriers (eg ReRoot 600), to Engineer's requirements.

Trees in car park to be fitted with irrigation / aeration tube (eg Greenleaf 'RootRain Civic' 60mm dia). Tree impact protection to architects details.

All trees to have a clear 1 metre diameter mulch bed.

**WATERING & MAINTENANCE**  
All planting and grassing is to be watered and maintained up to Practical Completion and for a period of 12 months from that date. Any plant or area of turf which dies, or is not thriving during this period is to be replaced.

Conservation grass area to be cut to 75mm during June, July, August, September & October. Clippings to lay fallow for 3-5 days before being collected and taken to recycling facility.

**CAMBIUM : Landscape architecture | Arboricultural consultancy**

Project  
**ALDI Store, Mon Bank, Newport**

Title  
**Soft Landscape Proposals**

Client  
**ALDI Stores Ltd**

|         |            |          |              |
|---------|------------|----------|--------------|
| Date    | July 2020  | Drawn    | LR           |
| Scale   | 1:250 @ A1 | Checked  | MW           |
| Dwg No. | 1390-01    | Revision | A            |
|         |            | Status   | <b>DRAFT</b> |

**Cambium, Bankpace 145-147 East Street Bedminster Bristol BS3 4EJ**

