

Aldi, Port Talbot

Store Waste Management Plan

(Based on Aldi's National Waste Policy)

Overview

- ALDI is committed to donating surplus food to those that need it most. Aldi are guided by the principle to reduce, reuse and recycle waste.
 - The ALDI South Group aims to achieve zero waste to landfill across all ALDI countries, and prioritise waste disposal methods according to the Waste Hierarchy.
-

Legislation

- All waste brokers and subcontractors are required to sign relevant Waste Transfer Notes and be able to produce the appropriate Waste Carrier's Licence.
-

Store Waste

- Within stores, waste is segregated into:
 - Cardboard
 - Plastic (polythene)
 - Food waste (food that is not fit for consumption - does not include meat waste)
 - Animal by-product (ABP) - i.e. raw meat, eggs
 - General waste (e.g. floor sweepings, customer-facing bins)
 - Other recyclables (e.g. metal, wood etc.)
 - General waste and ABP are collected via subcontractors managed by our national waste service provider, New Star Environmental.
 - Stores collect general waste in 1100L bins held in a locked bin cage at the rear of the store.
 - ABP bins, which are of a standard wheelie bin size, are held in store until collection by the subcontractor.
 - All other wastes / recyclables are backhauled via ALDI's logistical network to Regional Distribution Centres (RDCs).
 - Food surplus (ambient products that are fit for human consumption) is also segregated and backhauled to the RDC.
-

RDC Waste

- Food waste received from stores is transferred to a food waste bulker on site that is collected by a subcontractor managed by New Star Environmental.

- General waste is collected from RDCs via a subcontractor managed by New Star Environmental.
- Other wastes / recyclables (e.g. cardboard) are collected by contractors managed by the Logistics department in each ALDI Region.
- Food surplus received from stores at RDCs for donation to FareShare is consolidated and delivered to the local FareShare distribution centre on a regular basis.

General

- Aldi's regular weekly waste collection of the external bins ensures that they are effectively managed. The waste is minimal as all Cardboard, Polythene, store product and food waste is recycled and stored separately within the stores warehouse and collected by either Aldi distribution or a dedicated waste company.
- This plan will be kept under review and the waste collection frequency will be adjusted to avoid any overspill of waste as required.

Bin Store Location

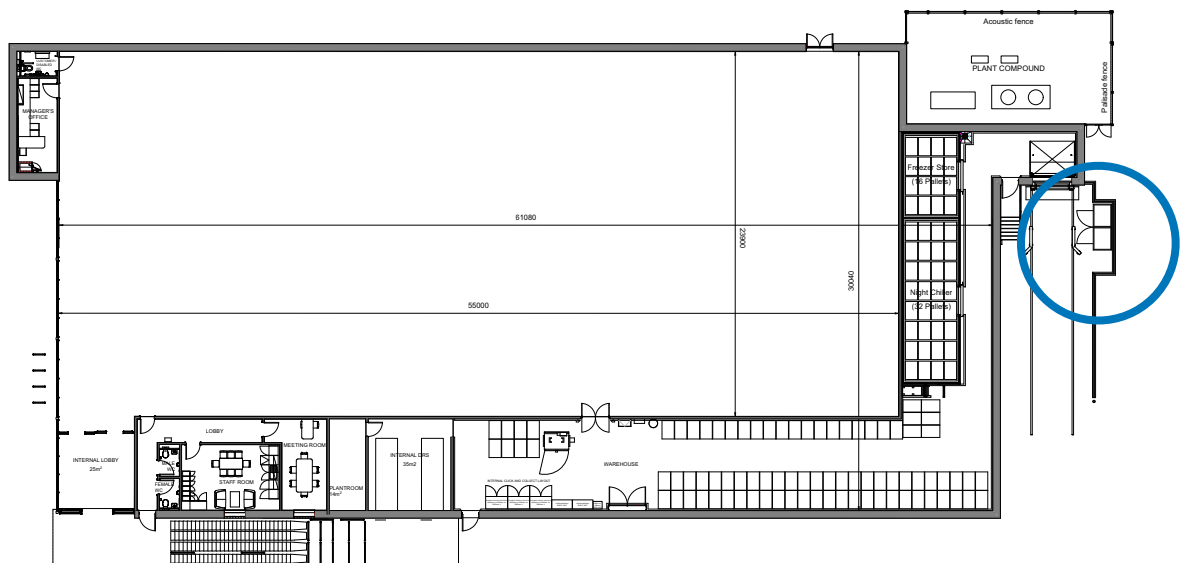

Store Floor Plan - Bin Store position highlighted by blue circle